

Dima foratura
Mounting hole

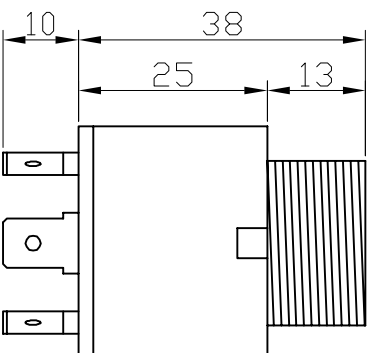
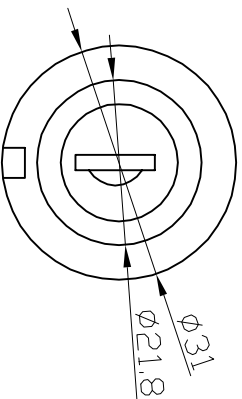

Tutte le dimensioni sono in mm / All dimension are in mm
 Chiave a 2 posizioni / 2 positions key: OFF - ON
 Corrente massima / maximum current: 17.5A (12V) - 10A (24V)
Codice prodotto / Product Code: CHA50100

Rev:	Date:	Descrizione modifiche - Description of changes:
0	06/12/17	Prima emissione
SAN GIORGIO S.E.I.N. GENOVA - ITALY		
Tel. 010-8301222 - www.sangioiogiosein.com		
Dimensionale chiave a 2 posizioni - CHA50100		
Number:	Sheet:	Date:
D171211	1/1	06/12/17
Completed:	Checked:	Approved:
Garzi P.	Mannelli M.	Mannelli M.
Size:		A4